



connect: SEPTEMBER 2018

Working Together For Our Children

Opening of Mount Brown Entrance



Dear Resident

Welcome to Resident Connect, this edition of Connect relates to the new entrance at the new children's hospital at Mount Brown, this newly created entrance is due to open in mid-September.

As part of the grant of planning by An Bord Pleanála, it has been agreed that construction vehicles will use both the Rialto entrance on the St. James's Campus and a newly created entrance at Mount Brown. It is likely that the majority of the construction traffic will access / exit the site via Rialto as it best serves the construction work as per grant of planning / Environmental Impact Study. There will be a wheel wash for construction vehicles located within the vicinity of the newly created entrance.

The new entrance at Mount Brown will be securely gated and located 15 metres in from the road, any construction vehicles entering the site at this location will be able to safely drive in off the road without blocking traffic and respect all users on the road. The entrance junction will form a priority junction with Mount Brown.



The new Mount Brown entrance is designed to serve:

- the construction phase of the new children's hospital
- service vehicles accessing the facilities yard within the basement of the new children's hospital and
- patient/visit cars accessing the basement car park once the new children's hospital becomes operational

When the hospital is operational, there are plans to provide a signalised pedestrian crossing on Mount Brown.

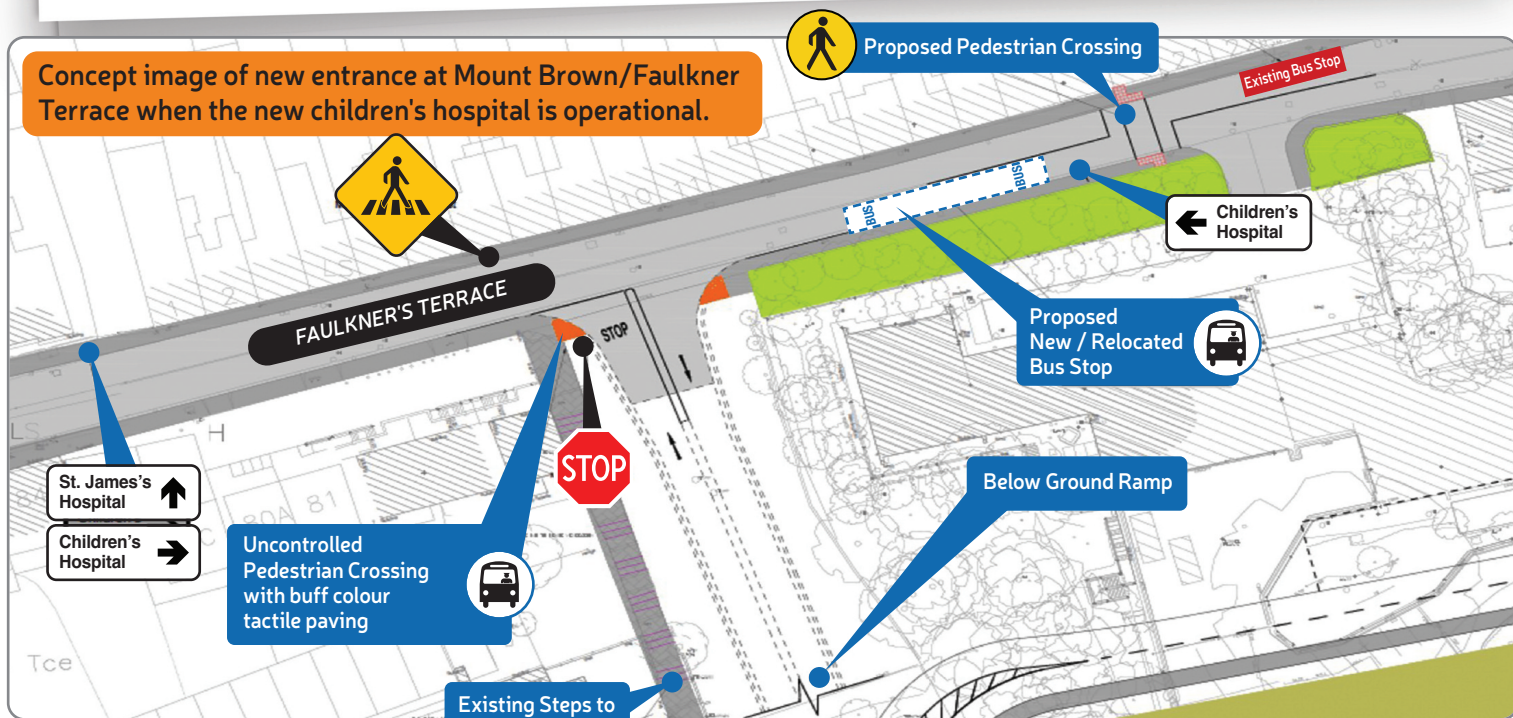

All construction traffic entering the construction site will enter the HGV cordon via the junction of South Circular Road / Mount Brown and South Circular Road / Suir Road.

St James's Hospital Campus Entrances

The three access junctions that will serve the St James's Hospital campus following the completion of the new children's hospital are:

- the Rialto entrance
- the existing James's Street entrance
- the Mount Brown entrance

There will also be a pedestrian entrance at the Rialto luas stop.

Vehicular access/exit to the construction site will be via the existing Rialto entrance and also via the Mount Brown Entrance.

All construction traffic exiting the construction site will be directed west out of the HGV cordon towards the South Circular Road (Kilmainham).



Davitt Road – Construction Compound

The new children's hospital includes the temporary opening of a construction compound on the former Unilever site at Davitt Road to support the construction of the new children's hospital. The construction compound recently opened and supports the storage of materials to allow for the orderly delivery of materials to the St. James's Hospital campus and to stage construction vehicles before proceeding to the campus.



24/7 RESIDENTS HELPLINE

01 531 1110

info@nph.ie

www.newchildrenshospital.ie

Further information on the mobility/traffic management for the new children's hospital can be found on our public website: <http://www.nchplanning.ie/wp-content/uploads/2015/07/Chapter-6-Traffic.pdf>

NPADB PROJECT OFFICE: Block A, Herberton, St. James's Walk, Rialto, Dublin 8. tel 01 556 4500 email info@nph.ie www.newchildrenshospital.ie



DESIGN
BUILD
EQUIP



connect:
SEPTEMBER 2018